

# FIREWALL STILO - INSTALLATION GUIDE

Before installing Firewalls, it is recommended to check any special requirements or restrictions according to local building regulations. Any construction or use of Déco products must comply with all local planning and/or building regulations. The diagrams and instructions in this guide are for illustrative purposes only and are not intended to replace a licensed professional. The consumer assumes all risks and responsibilities associated with the construction and use of these products.

## **SAFETY**

Be sure to wear protective clothing and safety equipment, such as safety goggles, gloves, dust masks and long sleeves, a procedure that must be carried out every time you work on a construction project

## **TOOLS**

You can use standard woodworking tools, including electric and impact drills.

We recommend the use of hard aluminium blades with negative 32 teeth.

Only Déco supplied accessories and standard stainless steel or appropriately coated screws should be used for installation, depending on the installation site.

## **DESIGN**

In order to install Déco products correctly, a clean, smooth, level and solid surface is required to support the weights and forces acting on the cladding.

Before installing any type of material, check the local building regulations. If installation does not take place immediately.

If installation does not take place immediately, Déco products should always be stored in a place protected from the weather and laid on a flat surface.

Déco Sunshades are NOT intended for use as columns, support posts, beams, stringers or other primary load-bearing components.

They may not be installed over existing cladding or be supported by a suitable sub-frame in accordance with these installation instructions.

## **EXCESSIVE HEAT**

Although the sunscreens are Bfl class certified, excessive heat from external sources such as fire or reflection of sunlight from energy efficient window products containing low-e glass can damage the surface of Firewall products. Current or potential Déco customers who have concerns about possible damage caused by low emissivity glass should contact the manufacturer of such products to find a solution that will reduce or eliminate the effects of reflected sunlight.

## **SCREWS**

Always use screws intended for use with composite material. Always test screws on a piece of scrap plank to ensure that the screws do not cause the surface of the planking to swell around the screw head.

All screws used must be long enough to be driven into the stiffening core.

All exposed-fixed screws must always be driven in at a 90-degree angle to the surface of the siding planks.

All exposed-fixed screws must always be stainless steel or suitably coated.

All fixed screws must be driven in with a pre-drilled hole 1 mm larger than the screw diameter.

## INSTALLATION

Slide the aluminium core into the Firewall Stilo sunscreen profile

For the Firewall Stilo S profile (50x25), use a 40x15 mm core.

For the Firewall Stilo L profile (100x50), use a 40x40 mm core.

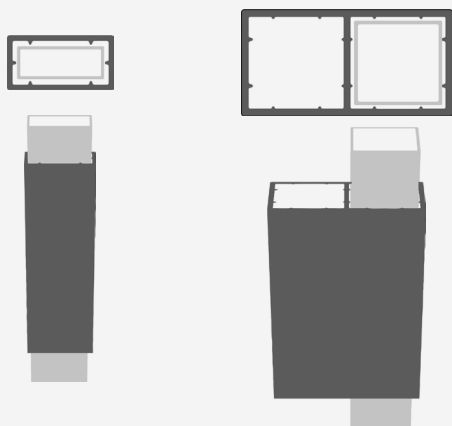

		INTERAXIS (I)	
SECTION mm	ALUMINIUM BAR SUGGESTED BY DÉCO	HORIZONTAL INSTALLATION	VERTICAL INSTALLATION
50X25 mm	40x15 mm	1500 mm	2000 mm
100x50 mm	40x40 mm	2000 mm	2500 mm

Fix the Firewall Stilo profiles to the joists with self-tapping screws to form a pre-assembled shielding module for subsequent installation.

Depending on the thickness and shape (U-shaped or square) of the joists, choose the appropriate length of screws to correctly fix the Firewall Stilo profiles, taking care to pre-drill the wpc 1mm larger than the diameter of the screw to allow for expansion and contraction of the material.

